

## Finished Hex Nuts

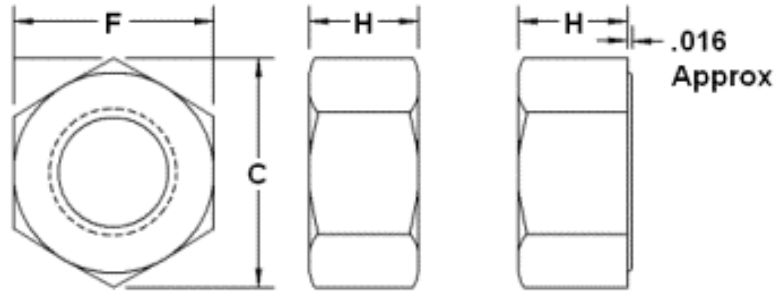

**Finished Pattern Nuts**

SAE J995 Grade 2, ASTM A563  
 SAE J995 Grade 5, ASTM A563  
 SAE J995 Grade 8, ASTM A563  
 Grade L9

Plain = NF020----  
 Plain = NF050----  
 Plain = NF080----

Zinc = NF020----Z1  
 Zinc = NF050----Z1  
 Zinc = NF080----Z1  
 Zinc = NF090----Z1

**Jam Pattern Nuts**

SAE J995 Grade 2, ASTM A563

Plain = NJ020----

Zinc = NJ020----Z1

Nominal Size	Coarse Thread	Fine Thread	Nominal Size	F		C		H	Full Nut Weight Per C	H	
				Width Across Flats		Width Across Corners		Thickness Hex Nut		Thickness Jam Nut	Jam Nut Weight Per C
				Basic	Max	Min	Basic				
1/4	20	28	1/4	7/16	0.505	0.488	7/32	.7	5/32	.52	
5/16	18	24	5/16	1/2	0.577	0.557	17/64	1.1	3/16	.77	
3/8	16	24	3/8	9/16	0.650	0.628	21/64	1.6	7/32	1.05	
7/16	14	20	7/16	11/16	0.794	0.768	3/8	2.8	1/4	1.86	
1/2	13	20	1/2	3/4	0.866	0.840	7/16	3.8	5/16	2.62	
9/16	12	18	9/16	7/8	1.010	0.982	31/64	5.8	5/16	3.68	
5/8	11	18	5/8	15/16	1.083	1.083	35/64	7.3	3/8	4.93	
3/4	10	16	3/4	1-1/8	1.299	1.240	41/64	11.9	27/64	7.70	
7/8	9	14	7/8	1-5/16	1.516	1.447	3/4	19.0	31/64	12.00	
1	8	14	1	1-1/2	1.732	1.653	55/64	28.3	35/64	17.6	
1-1/8	7	12	1-1/8	1-1/4	1.949	1.859	31/32	40.3	39/64	24.7	
1-1/4	7	12	1-1/4	1-7/8	2.165	2.066	1-1/16	54.3	23/32	36.1	
1-3/8	6	12	1-3/8	2-1/16	2.382	2.273	1-11/64	73.0	25/32	47.90	
1-1/2	6	12	1-1/2	2-1/4	2.598	2.480	1-9/32	94.3	27/32	60.90	
1-5/8	5	12	1-5/8	2 7/16			1-25/64	117			
1-3/4	5	12	1-3/4	2-5/8			1-1/2	151			
1 7/8	5	12	1 7/8	2-3/4			1-3/4	204			
2	4.5	12	2	3			1-23/32	224			
2 1/4	4.5	12	2 1/4	3-3/8			1-59/64	317			
2 1/2	4	12	2 1/2	3-3/4			2-9/64	435			
2 3/4	4	12	2 3/4	4-1/8			2-23/64	5473			
3	4	12	3	4-1/2			2-37/64	740			

Dimensional specifications per ASME B18.2.2